

SGT

O-ring

Lock-ring

Width
2.5~4.1mm

Width
1.15~4.2mm

3
Corners

External grooving

SGT R/L

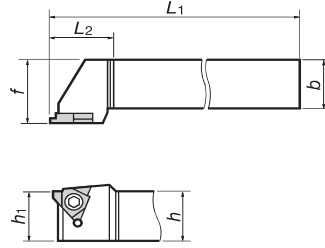
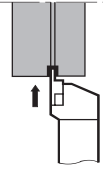

Right hand (R) shown.

Cat. No.	Stock		Applicable inserts	Dimensions (mm)					Clamping screw	Wrench		
	R	L		h_1	b	h	L_1	L_2			f	
SGTR/L1616-3	○	○	GLR/L3□□□	16	16	16	100	20	20	CSTB-4	T-15F	
SGTR/L2020-3	○	○		20	20	20	125					25
SGTR/L2525-3	○	○		25	25	25	150					32
SGTR/L2020-4	○	○	GLR/L4□□□ GOR/L4□□□	20	20	20	125	30	25	CSTB-5	T-20F	
SGTR/L2525-4	○	○		25	25	25	150					32
SGTR/L3232-4	○	○		32	32	32	170					40

Applicable Inserts

GOR/L (O-ring)

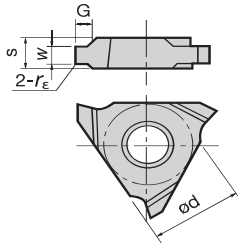

Right hand (R) shown.

Dimensions (mm)			Insert Cat. No.	Grades				Dimensions (mm)	
$W_{+0.1}^{+0.05}$	G	r_E		Cermet		Uncoated		ϕd	s
				NS9530	UX30	R	L		
2.5	1.5	0.4	GOR/L4190	○	○	○	12.7	4.76	
3.2	2	0.4	GOR/L4240	○	○	○			
4.1	2.5	0.7	GOR/L4310	○	○	○			

External grooves for JIS O-ring for static and dynamic use, nominal sizes: P3 ~ P10, P10A ~ P22, and G25 ~ G145.

GLR/L (Lock-ring)

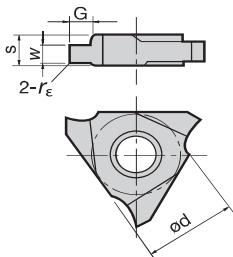

Right hand (R) shown.

Dimensions (mm)			Insert Cat. No.	Grades				Dimensions (mm)	
$W_{+0.1}^{+0.05}$	G	r_E		Cermet		Uncoated		ϕd	s
				NS9530	UX30	R	L		
1.15	1.5	0.1	GLR/L3115	○	○	○	9.525	3.18	
1.35			GLR/L3135	○	○	○			
1.65			GLR/L3165	○	○	○			
1.75	2	0.1	GLR/L3175	○	○	○	9.525	3.18	
1.9			GLR/L3190	○	○	○			
1.95	2.5	0.1	GLR/L3195	○	○	○	9.525	3.18	
2.2			GLR/L3220	○	○	○			
2.7	3	0.1	GLR/L3270	○	○	○	9.525	3.18	
2.7			GLR/L3270	○	○	○			
1.15	1.5	0.1	GLR/L4115	○	○	○	12.7	4.76	
1.35			GLR/L4135	○	○	○			
1.65			GLR/L4165	○	○	○			
1.75	2	0.1	GLR/L4175	○	○	○	12.7	4.76	
1.9			GLR/L4190	○	○	○			
1.95	2.5	0.1	GLR/L4195	○	○	○	12.7	4.76	
2.2			GLR/L4220	○	○	○			
2.7	3.5	0.1	GLR/L4270	○	○	○	12.7	4.76	
3.2			GLR/L4320	○	○	○			
4.2	4	0.1	GLR/L4420	○	○	○	12.7	4.76	

JIS C-type retaining rings for shaft, nominal sizes: 10 ~ 80.
 JIS E-type retaining rings for shallow grooves, nominal sizes: 10 ~ 24.
 JIS C-type retaining rings for shaft, nominal sizes: 20 ~ 80.

JIS C-type retaining rings for shaft, nominal sizes: 10 ~ 120.
 JIS E-type retaining rings for shallow grooves, nominal sizes: 10 ~ 24.
 JIS C-type retaining rings for shaft, nominal sizes: 20 ~ 200.

Standard cutting conditions

Grades	Cutting speed V_C (SFM)	Feed: f (in/rev)		
		$W < .078"$	$W = .078" \sim .157"$	$W > .157"$
NS9530	260 ~ 650	.002 ~ .004	.003 ~ .008	.003 ~ .010
UX30	200 ~ 500	.002 ~ .004	.003 ~ .008	.003 ~ .010

○ : Stocked in Japan